

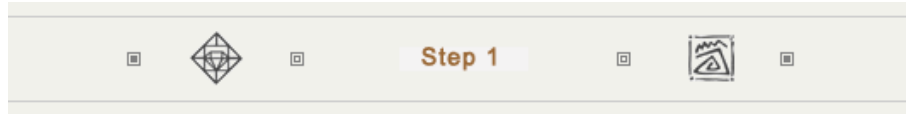

» Welcome, Michelle Breaux
Log Out | Edit User Profile | About SAAC EZ

Student Academic Achievement Committee (SAAC) EZ



SAVE often - use the "Save" button at the bottom to save the information you have entered

Enter a title for this assessment study

Identify where the course is taught [Help](#)

Division

Course Prefix + Course Number + Suffix (if any) [Help](#)

Other

Is your course associated with any of these?

- Honors
- Service learning
- Hybrid
- Online

Tie to an Official Course Competency [Help](#)

What is the intended learning objective (course/discipline level) or learning outcome (program level)? [Help](#)

Tie to a General Education Ability [Help](#)

What do you do to help your students learn it? [Help](#)

Add a supplement (optional) [Help](#)

Which tool (quiz, portfolio, homework, etc) do you use to show how the students learned it AND how is it evaluated (points, completion, etc)? [Help](#)

Add a supplement (optional) [Help](#)



» Welcome, Michelle Breaux
Log Out | Edit User Profile | About SAAC EZ

Student Academic Achievement Committee (SAAC) EZ

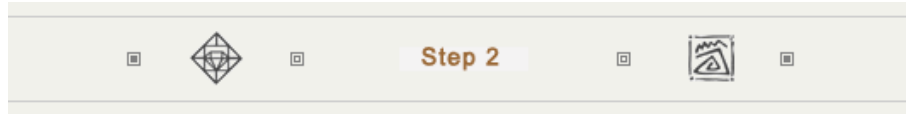

SAVE often - use the "Save" button at the bottom to save the information you have entered

Results: how did they do? Please include the semester corresponding to your data. [Help](#)

Please rate the need for improvement [Help](#)

- (Low)
- (Medium)
- (High)

If needed, what is your improvement plan? [Help](#)

Add a supplement (optional). [Help](#)

-
-
-
-





» Welcome, Michelle Breaux
Log Out | Edit User Profile | About SAAC EZ

Student Academic Achievement Committee (SAAC) EZ

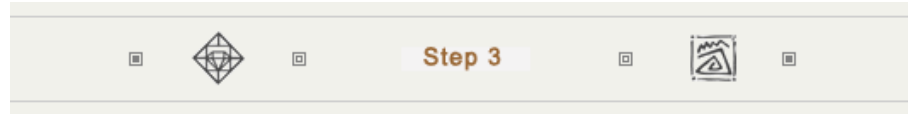

► Please [review](#) your ideas for improving the results to make certain an accurate description of what you did is provided, or [exit](#) until the ideas are implemented.

SAVE often - use the "Save" button at the bottom to save the information you have entered

Based on your improvement plan, how did they do?
Please include the semester corresponding to your new data. [Help](#)

Please rate your improvement plan [Help](#)



(Highly recommended)



(Recommended)



(Not recommended)

Add a supplement (optional). [Help](#)